

# Simple, Flexible, Easy to Install

Intel® SDM Ready Display



Hybrid SDM  
Slot Design



Ultra High Resolution



High Brightness

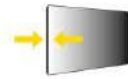

Stylish Thin Design



Long Operational  
Hours (24hrs/7days)

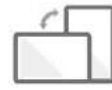

Portrait /  
Landscape

AUO SDM display series features the integrated Intel® Smart Display Module (Intel® SDM) for digital signage and video wall applications. Retailers and system integrators alike, are searching for simple all-in-one solutions with hassle free operations. The AUO SDM series delivers on these requirements by providing a scalable, future proof, plug and play solution.

The AUO SDM series is designed to handle the rigors of 24 / 7 commercial applications but flexible enough to support easy upgrades and repairs. The feature rich scalable platform allows for simple installation, extended compatibility and the ability to fit into a diverse set of markets.

## Key Features

- Supports Intel® SDM specifications with plug-in PC options
- Supports various generations of Intel processors including Intel Atom® and Intel® Core™ processors
- Simplified hybrid slot design is compatible with both Intel® Smart Display Module Small and Large
- Plug and play SDM for easy installation and maintenance that's also upgradable
- Highly flexible. Capable of supporting a variety of peripheral devices and operating systems
- Commercial grade reliability and quality

# Intel® SDM The Smart New Option

The Intel® SDM has evolved from the Open Pluggable Specification (OPS). It offers a smaller form factor and can be powered by a wide range of Intel® processors. The player is available in two form factors the SDM-S and the larger SDM-L. Intel® SDM-S is roughly the size of a credit card, ideal for low power consumption, basic signage applications. Intel® SDM-L is designed for high-performance computing implementation. These units provide users with the flexibility to select the platform and features that best support their needs.



## AUO SDM Displays Most Compatible Solutions

The AUO SDM series offers its users the compatibility, ease of installation, simplified maintenance, and clear path for upgrades that the industry requires. Our industrial-grade panels ensure longevity and reliability in the most demanding of environments. AUO makes it easier than ever for customers to take advantage of high performance displays, flexible integrated media players, and clean integrations in a simple to install, all-in-one package.



SDM FHD signage



SDM UHD signage

## UHD 4K SDM Series Stylish Even Bezel Design

AUO's UHD 4K SDM series delivers outstanding picture quality with vivid details and realistic images. Sharp, clear content and text make your application come to life. Coupled with a 4-sided even bezel design, the new UHD 4K SDM product lineup provides an immersive and seamless viewing experience.

In addition, USB plug-and-play allows content to be loaded in seconds. Connecting multiple displays is simplified by daisy chaining the displays via HDMI.



## AUO Hybrid Slot Design Compatible with both Intel® SDM-S and -L

AUO's unique hybrid slot design is compatible with both of the Intel SDM formats. This allows users greater flexibility in selecting the computing engine that's optimized for their specific needs.

The Intel® SDM-S is designed for simple digital signage applications such as transportation routes and timetables, information screens or a standalone advertising display. Intel®'s SDM-L is the perfect solution for enterprise digital signage applications, large video walls, menu boards, interactive retail displays and other IoT applications.



# Easy Installation, Upgrade and Maintenance

The AUO SDM displays eliminate the limitations of SoC. SDM is fully compatible with Windows, Android, and Linux based OS solutions allowing for more CMS options. Unlike the SoC solutions, the SDM offering is fully upgradable and can be repaired. SDM further enhances the solution by reducing cabling and the need to mount an external media player.

AUO SDM displays can be installed easily with just a single power cord. The embedded player can be upgraded or replaced by simply swapping out the card. The plug-and-play system also makes onsite service and maintenance simple, while saving installation time and labor cost.

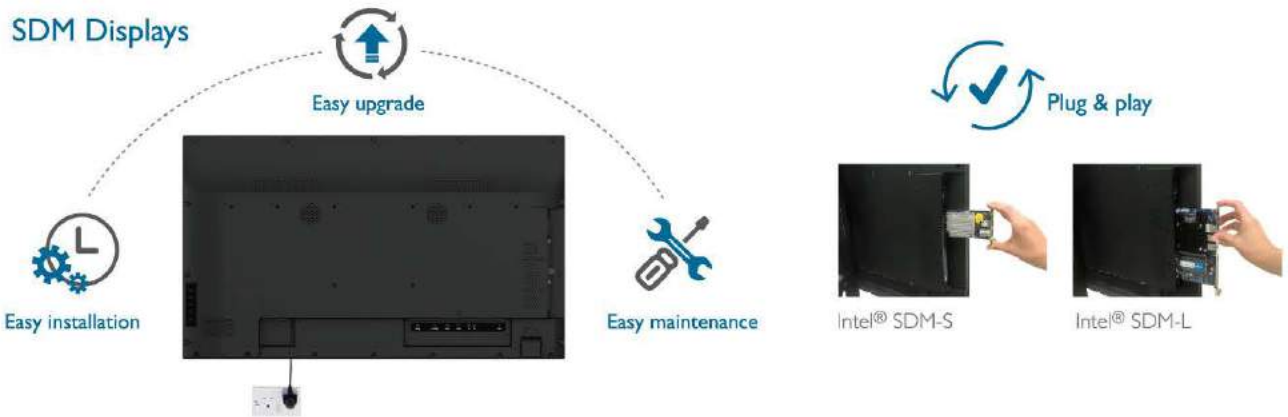

## Media Player

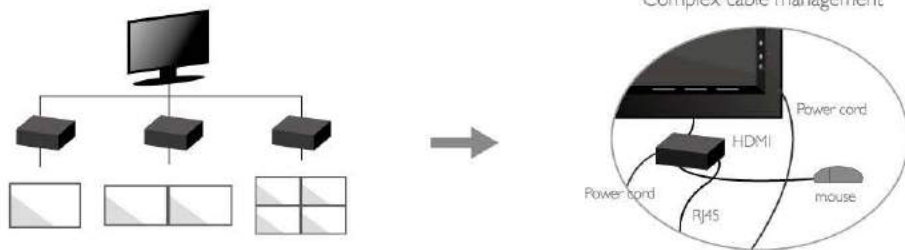

## SoC Digital Signage



# Maximum Integration and Flexibility

In addition to compatibility with Windows, Android, and Linux OS platforms, the SDM players offers more functionality and flexibility in the support of a variety of peripheral devices such as sensors, cameras and RFID readers for creating a more complete customer experience. This simple but powerful system enables integrators to provide enriched interactions and increase consumers' engagement while lightening their work load.





### Product Specification

Product Name	PUSDM55A	PUSDM65A	PUSDM75A	PUSDM85A
Model	55" SDM	65" SDM	75" SDM	85" SDM
Resolution	3840 x 2160	3840 x 2160	3840 x 2160	3840 x 2160
Brightness	500 nits	500 nits	500 nits	500 nits
Contrast Ratio	4000:1	4000:1	4000:1	4000:1
I/O (Signal Input)	HDMI x2, DP x1, USB x1	HDMI x2, DP x1, USB x1	HDMI x2, DP x1, USB x1	HDMI x2, DP x1, USB x1
I/O (Signal Output)	HDMI x1	HDMI x1	HDMI x1	HDMI x1
I/O (Control)	RS232 x1 (In), RS232 x1 (Out) IR x1 (In), IR x1 (Out)	RS232 x1 (In), RS232 x1 (Out) IR x1 (In), IR x1 (Out)	RS232 x1 (In), RS232 x1 (Out), IR x1 (In), IR x1 (Out)	RS232 x1 (In), RS232 x1 (Out), IR x1 (In), IR x1 (Out)
I/O (Audio)	Audio x1 (Out)	Audio x1 (Out)	Audio x1 (Out)	Audio x1 (Out)
SDM Slot	Intel® SDM-S and -L Compatible (12V / 5A)	Intel® SDM-S and -L Compatible (12V / 5A)	Intel® SDM-S and -L Compatible (12V / 5A)	Intel® SDM-S and -L Compatible (12V / 5A)
Speaker	10W x 2	10W x 2	10W x 2	10W x 2
Power Consumption (typ.)	145W	170W	240W	280W
Outline Dimension (mm)	1238 x 708.8 x 59.2	1458.3 x 833.4 x 60	1675.7 x 953.7 x 80	1910.8 x 1091.2 x 80
Weight (kg)	20	35	62	76
Wall Mount (mm)	VESA 400 x 400	VESA 400 x 400	VESA 400 x 400	VESA 400 x 400
Product Life	50,000hr	50,000hr	50,000hr	50,000hr
Operation Hours	24 / 7	24 / 7	24 / 7	24 / 7
Operation Mode	Portrait / Landscape			



### Product Specification

Product Name	PFSDM32A	PFSDM43B	PFSDM50A	PFSDM55B
Model	32" SDM	43" SDM	50" SDM	55" SDM
Resolution	1920 x 1080	1920 x 1080	1920 x 1080	1920 x 1080
Brightness	500 nits	500 nits	500 nits	500 nits
Contrast Ratio	4000:1	4000:1	4000:1	4000:1
I/O (Signal Input)	HDMI x1, DP x1, DVI-D x1, D-SUB x1	HDMI x1, DP x1, DVI-D x1, D-SUB x1	HDMI x1, DP x1, DVI-D x1, D-SUB x1	HDMI x1, DP x1, DVI-D x1, D-SUB x1
I/O (Control)	RS232 x1 (In), IR x1 (In)	RS232 x1 (In), IR x1 (In)	RS232 x1 (In), IR x1 (In)	RS232 x1 (In), IR x1 (In)
I/O (Audio)	Audio x1 (In), Audio x1 (Out)	Audio x1 (In), Audio x1 (Out)	Audio x1 (In), Audio x1 (Out)	Audio x1 (In), Audio x1 (Out)
SDM Slot	Intel® SDM-S and -L Compatible (12V / 5A)	Intel® SDM-S and -L Compatible (12V / 5A)	Intel® SDM-S and -L Compatible (12V / 5A)	Intel® SDM-S and -L Compatible (12V / 5A)
Speaker	10W x 2	10W x 2	10W x 2	10W x 2
Power Consumption (typ.)	35W	60W	150W	80W
Outline Dimension (mm)	725.8 x 420.3 x 57.9	971.5 x 567.5 x 53	1132.6 x 655.8 x 69.9	1242.4 x 722 x 53
Weight (kg)	8.8	10	14	17
Wall Mount (mm)	200 x 100	VESA 200 x 200	VESA 200 x 200	VESA 300 x 300
Product Life	50,000hr	50,000hr	50,000hr	50,000hr
Operation Hours	24 / 7	24 / 7	24 / 7	24 / 7
Operation Mode	Portrait / Landscape			

Note: Optional signal output x1 via SDM mode



As an introductory incentive, the AUO SDM Series displays are being offered with an industry leading 5 year warranty on all displays purchased prior to 12/31/2020.

## US CONTACTS

AU Optronics Corporation America  
37085 Grand River Ave., Suite 340,  
Farmington, MI 48335, USA

Texas | San Diego / Irvine

Sales

Tel: +1-408-518-8800 ext.1212

Email: SalesUS@auo.com

Partner Relations

Dave Adam

Tel: + 1-919-270-6722

Dave.Adams@auo.com



Email: SalesUS@auo.com  
PID.AUO.COM

Dealer Stamp

© 2020 AU Optronics Corp. All rights reserved. Information may change without notice.  
The Intel logo is a trademark of Intel Corporation or its subsidiaries in the U.S. and/or other countries.  
All other trademarks are the property of their respective owners.